

TITLE: Replacing the ME220 Quick Disconnect Cap

The Quick Disconnect Insert and Cap Assembly connects the Supply and Waste Bottles to the ME220 *Water Works* System.

Included

Supply Quick Disconnect Cap (1)

Waste Quick Disconnect Cap (1)

Plastic Dip Tube (1)

1. Disconnect the bottle by pressing the thumb latch on the Quick Disconnect Cap. See Figure 1.

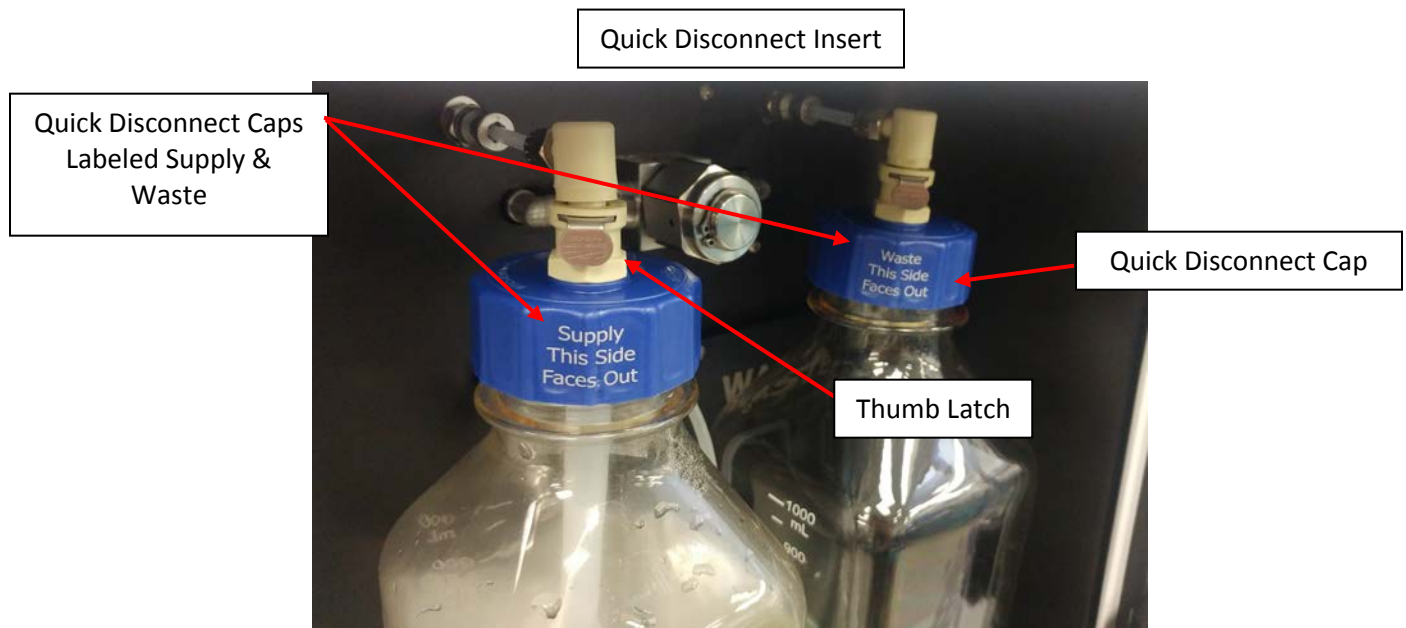

Figure 1 – Quick Disconnect Components

2. Remove the existing Quick Disconnect Cap and discard.
3. If replacing the Supply Bottle Cap, locate the tube stem on the underside of the replacement Quick Disconnect Cap. Slide the dip tube over it.

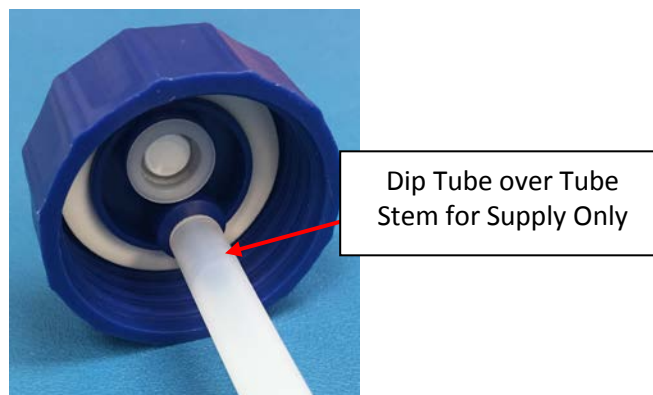

Figure 2 – Connecting the Dip Tube to the Supply Cap

4. Thread each Quick Disconnect Cap onto the appropriate bottle (Supply Cap to Supply Bottle and Waste Cap to Waste Bottle) until it is finger-tight.
5. Orient the bottle in the *Water Works* Bay with the label on the Quick Disconnect Cap facing out, as shown in Figure 3.



Figure 3 – Connecting the Bottle to the *Water Works* System

6. Reconnect the bottle by pressing the Quick Disconnect Insert into the coupling on the Quick Disconnect Cap until it clicks into place.